

IMPORTANT SAFETY INSTRUCTIONS

When using electrical appliances, especially when children are present, basic safety precautions should always be taken, including the following:

READ ALL INSTRUCTIONS BEFORE USING KEEP AWAY FROM WATER

DANGER – Any appliance is electrically live, even when the switch is off.

To reduce the risk of death or injury by electric shock:

1. Always unplug appliance from electrical outlet immediately after using (except when charging unit).
2. Do not place or store appliance where it could fall or be pulled into a tub or sink.
3. Do not use appliance while bathing or in the shower.
4. Do not place appliance in, or drop into, water or other liquid.
5. If appliance has fallen into water, do not reach for it. Unplug immediately.
6. Unplug this appliance before cleaning.

DO NOT REACH INTO THE WATER

WARNING

To reduce the risk of burns, electric shock, fire, or injury to persons:

1. Never leave a plugged-in appliance unattended.
2. This appliance should not be used by, on, or near children or individuals with certain disabilities.
3. Use appliance only for its intended use as described in this manual. Only use attachments recommended by the manufacturer. Do not use an extension cord to operate the appliance.
4. Never operate the appliance if it has a damaged cord or plug, is not working properly, has been dropped or damaged, or dropped into water. Return the appliance to a Conair service centre for examination and repair.
5. Keep the appliance cord away from heated surfaces.
6. Do not pull, twist or wrap the cord around the appliance.
7. Never drop or insert any object into any opening of the appliance.
8. Do not place the appliance on any surface while it is operating.
9. Do not use the appliance with a damaged or broken comb or with teeth missing from the blades, as injury may result. Before each use, make certain the blades are aligned properly and oiled.
10. Do not use the appliance outdoors or where aerosol (spray) products are being used or oxygen is being administered.
11. **THIS PRODUCT IS FOR HOUSEHOLD USE ONLY.**
12. CAN ICES-3(B)

USER MANUAL FOR ADAPTOR

BEFORE USING THE CLASS 2 POWER SUPPLY, READ THESE INSTRUCTIONS CAREFULLY.

Use with adapter CA51

Rated input voltage: 100-240Vac, 50/60Hz, 0.2 A

Rated output: 6VDC,70mA

OPERATION

1. For dry location use only. Do not expose to rain.
2. When not in use, unplug unit completely.
3. Never operate this unit if the specification is out of the rating.
4. When using this unit, a warm temperature will be reached.

CAUTION

1. Risk of electric shock, dry location use only or do not expose to liquid, vapor, or rain.
2. Do not shot the polarity (output cord).
3. Do not operate any appliance which has a damaged output cord or housing.
4. Always unplug the unit before cleaning or when not in use.
5. This power unit is intended to be correctly oriented in a vertical or floor mount position.
6. Be sure voltage is in correct voltage before plugging in.

SAVE THESE INSTRUCTIONS

TROUBLESHOOTING

If your rechargeable trimmer does not seem to be taking a charge, take the following troubleshooting steps before returning it for repair:

1. Be sure the electrical outlet is working by plug-

ging in another appliance to test the outlet.

2. Make sure the electrical plug is not connected to a switch which turns power off when lights are turned off.
3. Be sure you have inserted the trimmer properly into the charging stand, that all connections are secure, and that the trimmer switch is in the “OFF” position.

OPERATING INSTRUCTIONS:

1. Before using your trimmer for the first time, place the unit in the charging stand and charge it for 16 hours. Always place the trimmer in the base with the ON/OFF switch in the OFF position.
2. Always check to see if the charging light is on when you place the trimmer in the charging stand. The switch must face forward for the trimmer to slide properly into the base and fixed firmly.
3. Plug the adaptor into any wall outlet (at the voltage listed on the label affixed to the adaptor). Unplug adaptor when not in use.
4. The adaptor may become warm while charging. This is normal.

Preserving the batteries:

In order to maintain the optimum capacity of the rechargeable batteries, the unit should be recharged for 16 hours every 3 months approximately.

USER MAINTENANCE INSTRUCTIONS

CHARGING THE TRIMMER

1. Remove the trimmer and all accessories from the cradle and turn the cradle upside down. Turn over the safety flap, insert the plug into the hole provided by pressing firmly and close the flap. Slide the cord into the groove provided. Put the cradle back upright and plug in the adapter (Fig. 1)

2. Place the turned off trimmer in the charging cradle and check that the charging light is on.
3. Once fully charged, the trimmer can be used for 30 minutes.
4. Before using the trimmer for the first time, allow it to charge for 16 hours.
5. The subsequent charging times should be 8 hours.

Fig.1



IMPORTANT INFORMATION REGARDING THE NI-MH BATTERIES OF THIS UNIT

To obtain and maintain the longest battery life possible, allow it to charge for 16 hours approximately every three months. Moreover, full battery life of the unit will only be obtained after three complete recharge cycles.

ATTACHMENT AND REMOVAL OF ACCESSORIES

Make sure the unit is turned off before changing the trimmer heads and accessories. To attach a head, place the bottom of the accessory on the appliance and press the whole head in until it clicks. To remove a head, hold the handle in one hand and remove the head with the other by pushing it upwards (Fig. 2).

To remove the special cutting guide for the body, push one side of the guide upward.

Fig.2



WATER-WASHABLE HEADS

Remove the heads from the unit (as indicated above) before placing them under running water. Make sure that the used head is completely dry before using the appliance again.

USING THE CUTTING GUIDES

The cutting guide is very practical and guarantees a level cutting height.

IMPORTANT: Always put the cutting guide on BEFORE turning the trimmer on, and turn the trimmer off before removing it.

The cutting height of the trimmer is adjusted manually. To increase the cutting height, push the cutting guide upwards. To reduce it, push the guide down. The selected height is

Battery Disposal

This appliance contains a Nickel Metal Hydride battery. To protect the environment, this appliance and its battery must be disposed of safely. At the end of its life, please take this appliance to a recycling center, where the internal rechargeable battery should be removed by a professional and recycled separately. For more information about the recycling of electrical and battery-operated appliances, please contact your local council office or your household waste disposal service. For specific enquiries regarding the replacement of batteries in this product, please contact our Conair Consumer Care Line.

CONTAINS NICKEL-METAL HYDRIDE BATTERY. MUST BE COLLECTED, RECYCLED OR DISPOSED OF PROPERLY. DO NOT DISPOSE OF IN THE MUNICIPAL WASTE.



BATTERY REMOVAL INSTRUCTIONS

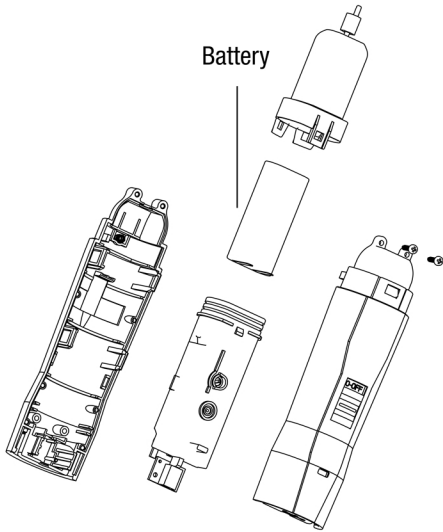

CORDLESS RECHARGEABLE BEARD TRIMMER MODEL GMT839C

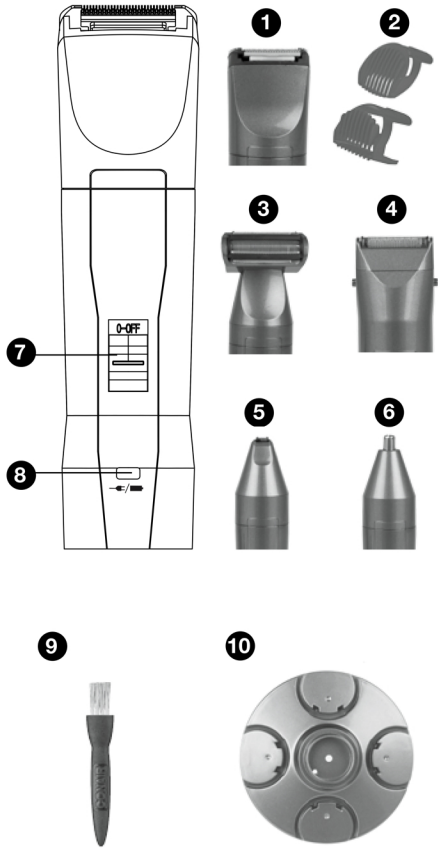

1. Blades
Movable blade: Stainless steel
Fixed blade: Stainless steel
2. 2 cutting guides (2-14mm and 3-15mm) for hair and beard
3. Special shaving head for the body + 1 cutting guide (3mm) for fast and uniform shaving of all parts of the body
4. Special shaving head (28mm) for the face
5. Precision blade (7mm), to precisely sculpt contours and original patterns
6. Nose/ears accessory, to remove unwanted nose and ear hair
7. I/O switch
8. Charge indicator light
9. Cleaning brush
10. Charging and storage cradle

LIMITED TWO-YEAR WARRANTY (U.S. AND CANADA ONLY)

Conair will repair or replace, at our option, your appliance free of charge for 24 months from the date of purchase if the appliance is defective in workmanship or materials.

To obtain service under this warranty, return the defective product to the service centre listed below, together with your sales slip and \$7.50 for postage and handling. In the absence of a receipt, the warranty period shall be 24 months from the date of manufacture.

ANY IMPLIED WARRANTIES, OBLIGATIONS, OR LIABILITIES, INCLUDING BUT NOT LIMITED TO THE IMPLIED WARRANTY OF MERCHANTABILITY AND FITNESS FOR A PARTICULAR PURPOSE, SHALL BE LIMITED IN DURATION TO THE 24-MONTH DURATION OF THIS WARRANTY.

IN NO EVENT SHALL CONAIR BE LIABLE FOR ANY SPECIAL, INCIDENTAL, OR CONSEQUENTIAL DAMAGES FOR BREACH OF THIS OR ANY OTHER WARRANTY, EXPRESS OR IMPLIED, WHATSOEVER.

This warranty gives you specific legal rights, and you may also have other rights which vary from province to province.

Please register this product at:
www.conair.com/registration

SERVICE CENTRE:
CONAIR CONSUMER PRODUCTS ULC
100 Conair Parkway
Woodbridge Ontario, L4H 0L2

©2018 CONAIR CONSUMER PRODUCTS ULC
For more information on any Conair product call:
1-855-926-6247
Visit our Web site: www.conaircanada.ca
Consumer Call Centre E-mail:
Consumer_Canada@Conair.com
18CN032980

IB-15540

MULTI-PURPOSE Rechargeable TRIMMER



Have a Question?

Please do not return this product to the retailer.

Call Us First!

Our customer service and product experts are ready to answer ALL your questions.

Please call our TOLL-FREE customer service number at:
1-855-926-6247
or visit us online at
www.conaircanada.ca

Instruction Booklet

For your safety and continued enjoyment of this product, always read the instruction booklet carefully before using.

CONAIRMAN

Respect the Ritual™

Model GMT839C